

DRIVEWAY

PARKING - 24/7 access - overnight allowed

DRIVEWAY

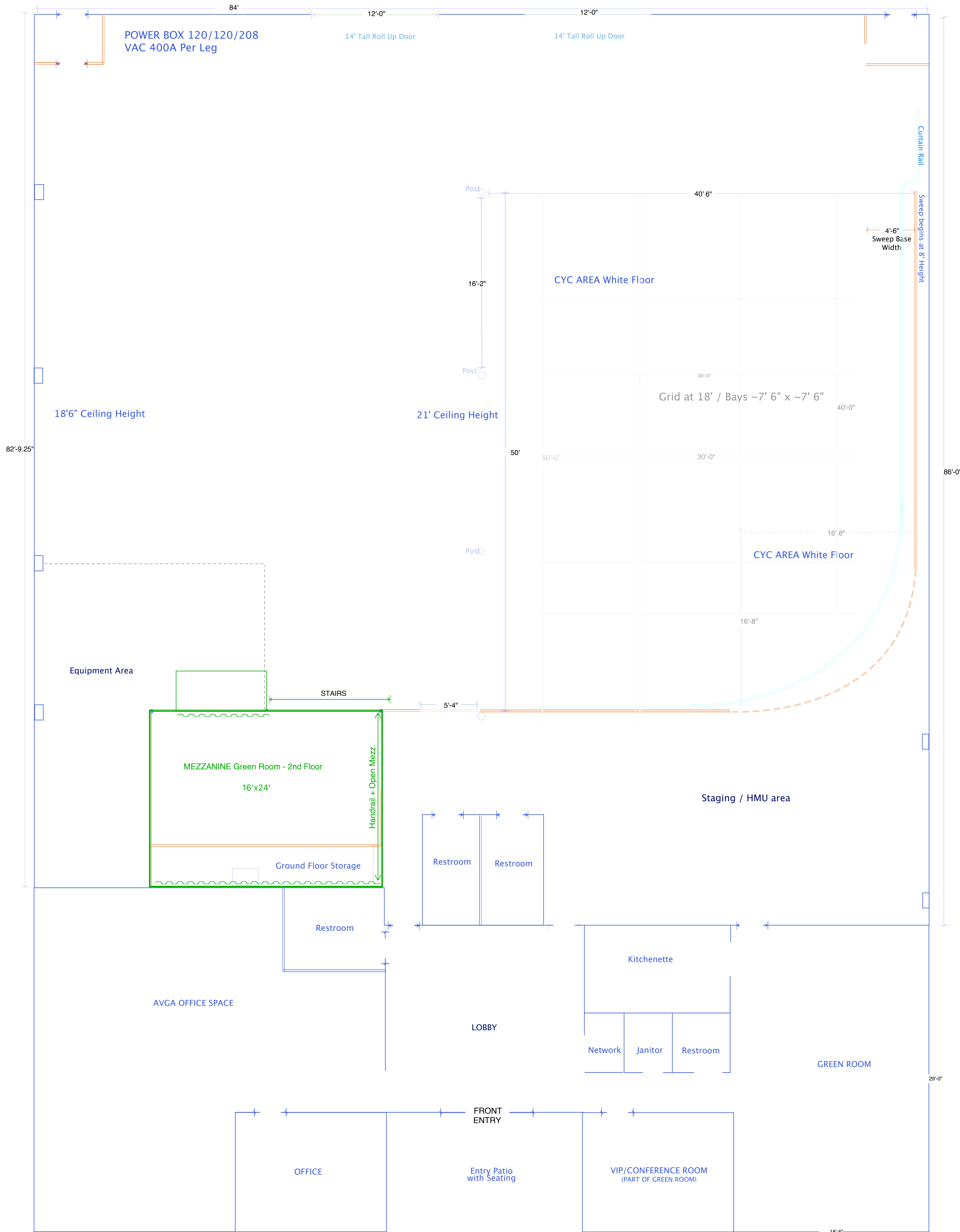

**Stage Specs**

- 84'x 65' Air Conditioned Stage
- 3,500 sq ft. of Production Office / HMU / Staging Area
- 40' x 50' White Cyc (Drive-on OK)
- 18'6" - 21' Ceiling Height
- 18' Pipe Grid
- Pre-Installed RGBw Lighting Environment
- 12' x 12' Softbox w/White Quasar and 12x Astera Hyperion
- Installed LumenRadio Stardust Wireless CMRX
- 2 x 14' Tall x 12' Wide Loading Doors
- Pre-Hung Retractable 100' x 17.6' Green Chroma Key Curtain
- Pre-Hung Retractable 100' x 17.6' Black Curtain
- Insul-Quilt Acoustic Baffling
- 1200 amps 120/120/208 Vac Camlock Power

**Production Support**

- On-site Grip, Electric, Lighting
- 4k/HD Streaming Package
- Camera Packages and Support
- Event and Playback Audio System
- Dedicated High-Speed Fiber Internet
- Ncam Mk II Reality System
- Ultimatte 12 w/Smart Remote
- Double Green Room w/Kitchenette, Private Bathroom and VIP Room
- Mezzanine Green Room w/Soft Seating
- Dedicated HMU and Wardroom Areas
- 2x Scissor Lifts
- 2Ample Parking + Easy Truck Access

**Contact**

15757 Stagg St.  
 Van Nuys, CA 91406  
 www.averygoodspace.com  
 info@averygoodspace.com  
 747.264.1413

Visit our website or call for additional information.